

Reduzierhülsen

Square reducers

ISO 5211 - DIN 3337 NAMUR

adaption

Beschreibung Description

- Reduzierhülsen zur Reduzierung des Innenvier- oder Innenachtkants von pneumatischen oder elektrischen Antrieben
- Vierkant gemäß ISO 5211 - DIN 3337 NAMUR
- Sehr hohe Toleranzgenauigkeit
- Abgerundete Ecken
- Material: Edelstahl 1.4408

- Reducers for the reduction of the internal square or double square of pneumatic or electric actuators
- Square according to ISO 5211 - DIN 3337 NAMUR
- Rounded edges
- Material: Stainless steel AISI 316

Model: RH

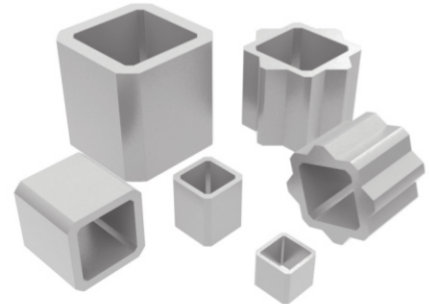

Maßzeichnung Dimensions

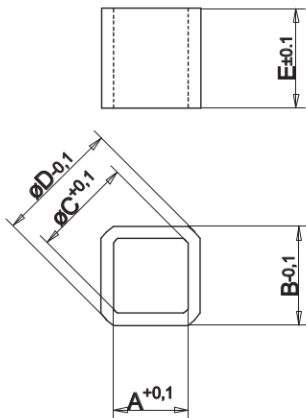

	RHE0906	RHE1106	RHE1108	RHE1109	RHE1409
A	6	6	8	9	9
B	9	11	11	11	13,95
C	8,20	8,20	11,10	12,20	12,30
D	11,70	14	14	14,30	17,80
E	10	12	12	10	16

	RHE1409-14	RHE1410	RHE1411	RHE1411-14	RHE1412
A	9	10	11	11	12
B	13,95	13,95	14	14	13,95
C	12,30	13,45	14,30	14,30	16,30
D	17,80	17,80	17,95	17,95	17,80
E	14	16	16	14	16

	RHE1711	RHE1712	RHE1714	RHE2216	RHE2217
A	11	12	14	16	17
B	17	17	17	22	22
C	14,30	16,40	18,30	21,30	22,50
D	22	22	22	28	28
E	17	17	17	21,60	22

	RHE2722	RHE3627
A	22	27
B	27	36
C	28,50	36
D	36	45
E	27	36

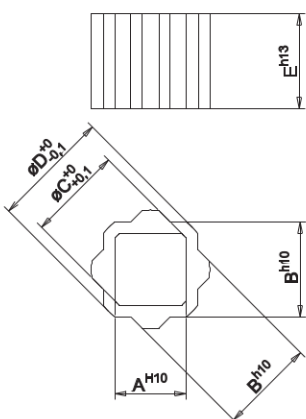

	RHX1109	RHX1409	RHX1411	RHX1711	RHX1714
A	9	9	11	11	14
B	11	14	14	17	17
C	12	12,30	14,30	14,30	18,30
D	14	18	18	22	22
E	11,90	14	14	17	17

	RHX2217	RHX2722
A	17	22
B	22	27
C	22,60	28,40
D	28	36
E	21,80	27